

Sales - House - Cancelada
2.680.000€

www.mibgroup.es
+34 662 58 96 58
info@mibgroup.es

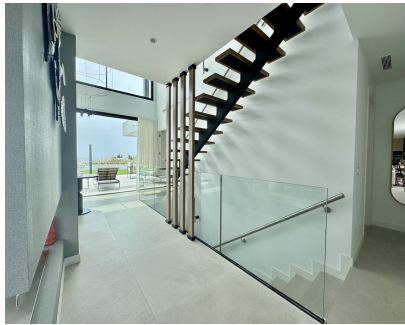

Ref.-ID: MIBGR5072929

IBI: 1,269 EUR / year

Cancelada



6



6.5



460 m2

House



1067 m2

Modern newly built villa with 6 bedrooms and 6 en-suite bathrooms, spread over 3 floors and located in an exclusive area, designed for those seeking luxury, comfort, and style. With 460sqm of built area and a southeast orientation, this property stands out for its impressive contemporary architecture, double-height ceilings, and large windows that flood every space with natural light, creating a perfect connection between indoors and outdoors. On the main floor, there is a spacious open-plan living area, decorated with minimalist taste and high-end finishes. From here, you have direct access to a covered terrace with a chill-out zone and a completely private pool, ideal for relaxing and enjoying the Mediterranean lifestyle. The terraces offer stunning panoramic views of the sea, the mountains, and the pool, making every corner a unique space to enjoy at any time of the day.. The villa features independent centralized air conditioning by zones, underfloor heating in all bathrooms, and a highly functional layout that guarantees privacy and comfort in every room.. On the basement level, there is an exclusive home cinema, perfect for enjoying entertainment with maximum comfort and privacy. A unique property, newly finished, ready to move in and enjoy a truly luxurious lifestyle...

Orientation

- ✓ East
- ✓ South East

Condition

- ✓ Excellent
- ✓ New Construction

Pool

- ✓ Private

Climate Control

- ✓ Air Conditioning
- ✓ Central Heating
- ✓ U/F Heating

Views

- ✓ Sea
- ✓ Mountain
- ✓ Garden
- ✓ Pool

Features

- ✓ Covered Terrace
- ✓ Private Terrace
- ✓ Utility Room
- ✓ Ensuite Bathroom
- ✓ Barbeque
- ✓ Double Glazing

Furniture

- ✓ Fully Furnished

Kitchen

- ✓ Fully Fitted

Garden

- ✓ Private
- ✓ Easy Maintenance

Security

- ✓ Alarm System

Parking

- ✓ More Than One
- ✓ Private

Category

- ✓ Luxury