

Sales - Commercial - Puerto Banús

1.029.000€

Puerto Banús

Commercial

Community: 2,160 EUR / year

Rubbish: 180 EUR / year



2



227 m2

These are two units linked together. Cristamar is a mall comprises by 114 local comercial in the heart of Puerto Banus, three levels with underground parking for your clients on the ground floor restaurants , shops, and services, pharmacy at the north corner a gym, and on the second floor offices

Setting

- ✓ Commercial Area
- ✓ Beachside
- ✓ Port
- ✓ Marina

Condition

- ✓ Good

Climate Control

- ✓ Air Conditioning

Features

- ✓ Covered Terrace
- ✓ Lift

Utilities

- ✓ Electricity
- ✓ Drinkable Water

Category

- ✓ Investment
- ✓ Resale







PLANTA ALTA

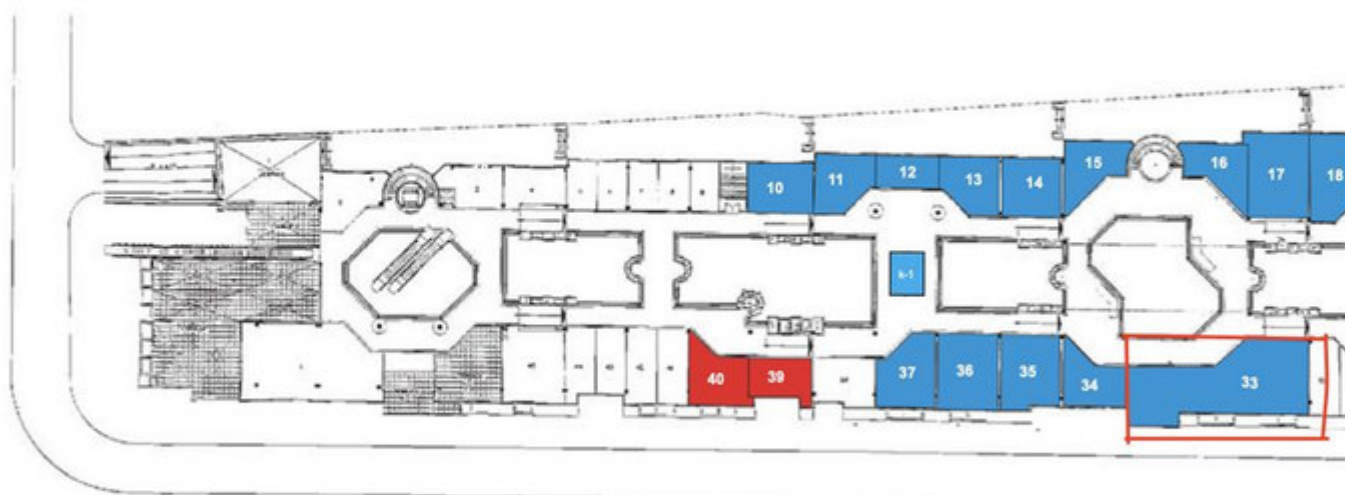

PLANTA RA.1A

PLANTA ALTA



PLANTA BAJA

