

Sales - Apartment - Estepona

245.000€

Estepona

Apartment

Community: 1,308 EUR / year

Rubbish: 200 EUR / year



2



1



73 m2

Here is a bright and nice apartment in the newly built Residencia Wellingtonia. Two bright bedrooms with large double curtains, one of which has its own exit to the terrace. Between the bedrooms a hallway with entrance to the toilet. The other facing the bright courtyard. Modern apartment in Scandinavian style! Open floor plan between kitchen and living room, from the living room we reach the second exit to the terrace of 12 sqm. Modern floor plan, fully equipped kitchen with stainless steel appliances dishwasher, washing machine, microwave, and fridge / freezer. Very cool apartment, ac is available in all rooms that can also be used as a heater during cold winter months. The apartment is equipped with fibre and satellite TV. The apartment also includes a large parking space in the garage. The apartment can be purchased fully furnished but also without furniture. The apartment is in the heart of Estepona. Only 250 metres from the city centre. 400 metres to the nearest large grocery store 900 metres to the beach with lots of restaurants and bars. 15 minutes to San Pedro. 20 minutes to Puerto Banus. 25 minutes to Sotogrande. 50 minutes to Malaga airport. The residential area has a very well maintained garden area, swimming pools and a padel court. During high season there is a lifeguard on site during the opening hours of the pools.

Setting

- ✓ Town
- ✓ Country
- ✓ Commercial Area
- ✓ Close To Shops
- ✓ Close To Sea
- ✓ Close To Town
- ✓ Close To Schools
- ✓ Close To Forest
- ✓ Urbanisation

Climate Control

- ✓ Air Conditioning
- ✓ Hot A/C
- ✓ Cold A/C
- ✓ Central Heating

Kitchen

- ✓ Fully Fitted

Utilities

- ✓ Drinkable Water

Orientation

- ✓ North East
- ✓ East

Views

- ✓ Mountain
- ✓ Country
- ✓ Courtyard
- ✓ Forest
- ✓ Street

Garden

- ✓ Communal

Category

- ✓ Investment
- ✓ Resale

Condition

- ✓ Excellent

Features

- ✓ Private Terrace
- ✓ Satellite TV
- ✓ WiFi
- ✓ Paddle Tennis
- ✓ Access for people with reduced mobility
- ✓ Fiber Optic

Security

- ✓ Gated Complex

Pool

- ✓ Communal
- ✓ Children`s Pool

Furniture

- ✓ Fully Furnished

Parking

- ✓ Underground

















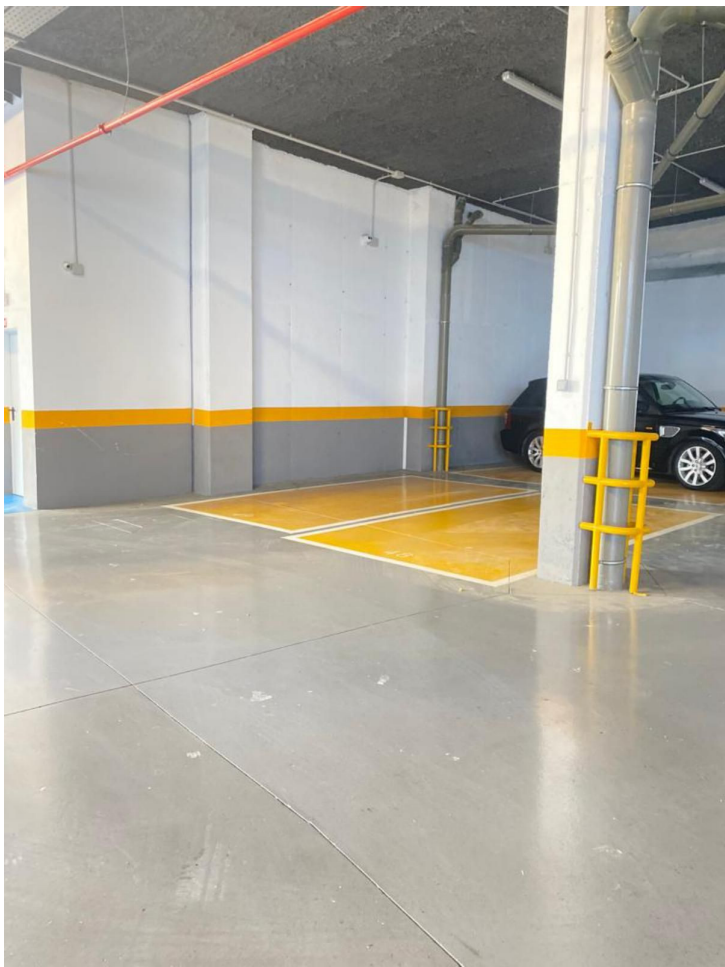

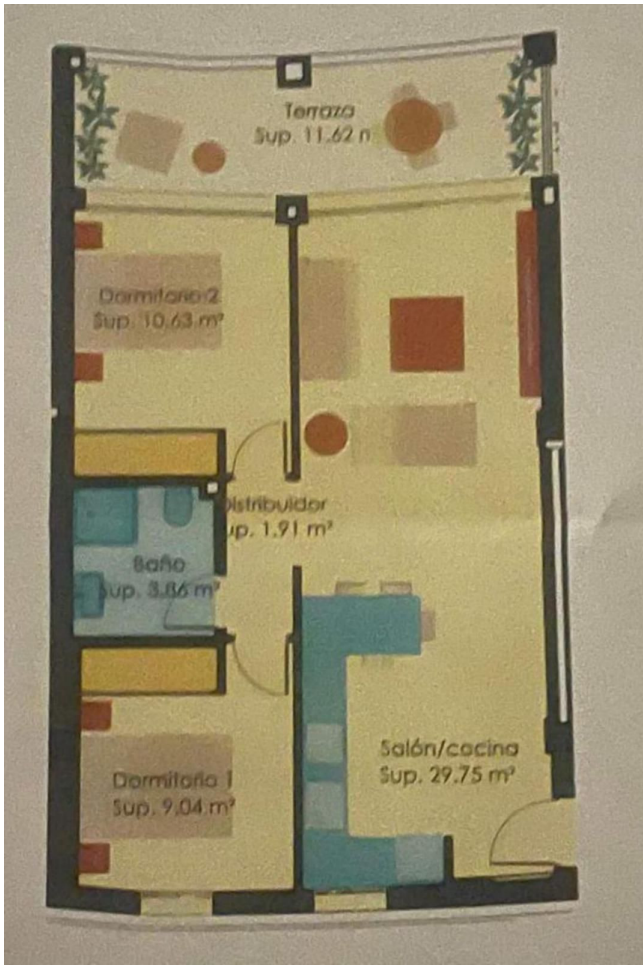

e:1/100

5m

Fase 1
Bloque 2

Escalera	Apartamento
P3	3-4A
Número de dormitorios	2+1
Superf. terraza	12 m ²
Superf. útil total	67 m ²
Piscina opcional	NO
Superf. construida	64 m ²
Superf. construida + xx.cc.	85
Trastero n°	-
Aparcamiento n°	49