

Sales - Apartment - Puerto Banús

750.000€

Puerto Banús

Apartment



3



3



166 m2

Spacious 3-Bedroom Apartment with Open-Plan Living in the Heart of Puerto Banús Marina Description: This exceptional apartment offers 166m² of beautifully renovated living space, perfectly located in the lively Puerto Banús marina. Designed with comfort and style in mind, it combines modern interiors with a prime location just steps from the port. This is an exclusive listing presented by Costa del Sol Property. The property features three generous bedrooms and three elegant bathrooms. The open-plan layout seamlessly connects the living and dining area with a modern kitchen, creating a bright and spacious atmosphere, ideal for both relaxing and entertaining. A French balcony adds a touch of charm and allows natural light to flow throughout the home. Fully furnished and equipped with hot and cold A/C, this apartment is move-in ready and perfectly suited as either a luxury holiday home or a strong rental investment. Key Features 166m² of living space 3 spacious bedrooms & 3 stylish bathrooms Open-plan living and dining area with modern kitchen French balcony Fully furnished Air conditioning (hot & cold) Prime Location: Located in the heart of Puerto Banús, the property is surrounded by sandy beaches, exclusive boutiques, fine dining, vibrant nightlife, and trendy cafés—all within walking distance. Investment Potential: The property is rented out on a short-term basis, and the new owner has the option to continue with the rental arrangement, ensuring income from day one. A rare opportunity to own a stylish, spacious apartment in one of Marbella's most sought-after locations—perfect as a holiday retreat or a profitable investment.

Setting

- ✓ Town
- ✓ Beachside
- ✓ Port
- ✓ Close To Shops
- ✓ Close To Sea
- ✓ Close To Town
- ✓ Close To Schools
- ✓ Marina
- ✓ Close To Marina

Views

- ✓ Urban
- ✓ Street

Category

- ✓ Holiday Homes
- ✓ Investment

Orientation

- ✓ South

Features

- ✓ Covered Terrace
- ✓ Lift
- ✓ Fitted Wardrobes
- ✓ Near Transport
- ✓ Private Terrace
- ✓ Restaurant On Site

Condition

- ✓ Recently Renovated
- ✓ Recently Refurbished

Furniture

- ✓ Fully Furnished

Climate Control

- ✓ Air Conditioning
- ✓ Hot A/C
- ✓ Cold A/C

Kitchen

- ✓ Fully Fitted



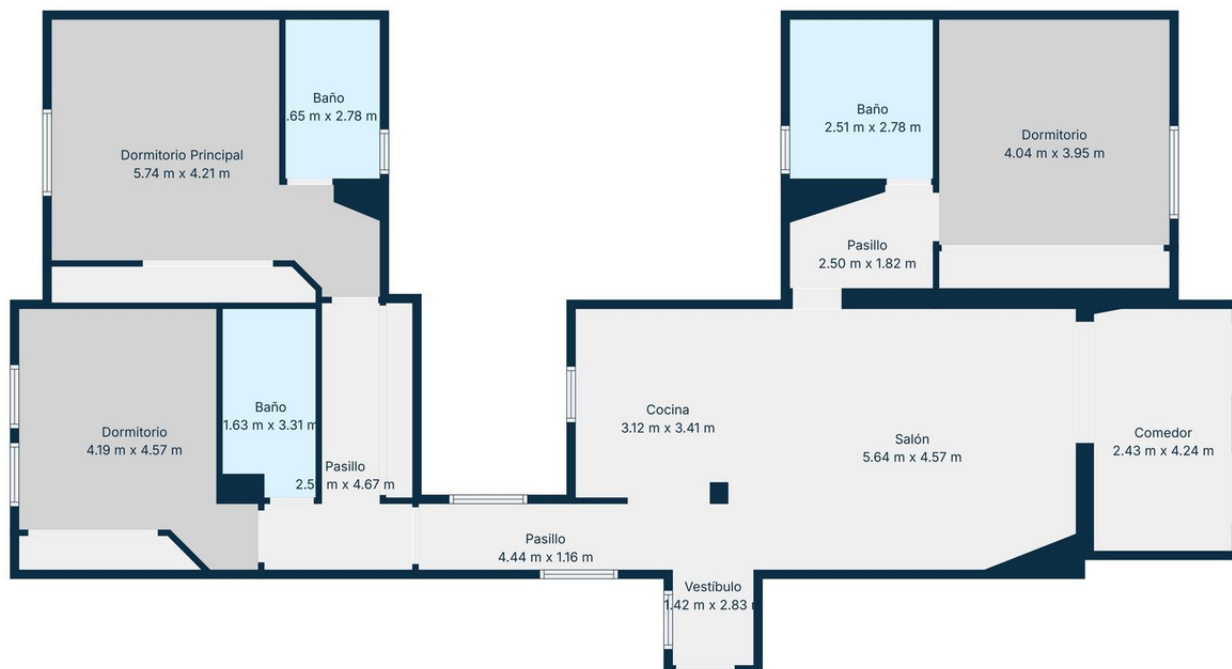

TOTAL: 152 m2
1. PLANTA: 152 m2
ÁREAS EXCLUIDAS: MUROS: 12 m2

Las Medidas Son Calculadas Utilizando La Tecnología Cubicasa. Son De Alta Fiabilidad Pero No Garantizadas.

















