

## Sales - House - Torremolinos

# 915.000€

Torremolinos

House



5



5



288 m2



754 m2

Discover this magnificent single-storey detached house located in El Pinillo, just 7 minutes' walk from the Cercanías train station, Mercadona, Carrefour, and a full range of services. Set in a quiet, family-friendly area with south-facing orientation, the home enjoys natural light throughout the day. The main house offers 4 bedrooms (with the option to convert the current laundry room into a fifth bedroom) and a total of 4 bathrooms, 3 of them en-suite. The heart of the property is its spacious open-plan living room with a fully renovated and equipped kitchen. Large windows surround the entire living and kitchen area, providing abundant natural light and direct views of the surrounding terraces and the impressive 42 m<sup>2</sup> private swimming pool with built-in steps. The property boasts extensive terraces and covered porches, perfect for enjoying the Mediterranean climate, as well as 3 storage rooms. It also counts with solar panels. An independent apartment completes this exceptional property, featuring a living room, kitchen, bedroom, bathroom, wardrobe, and its own storage area, ideal for guests, family, or rental use. A unique opportunity to live in a quiet, well-connected residential area with a bright south orientation. Ready to enjoy from day one!

### Setting

- ✓ Close To Port
- ✓ Close To Shops
- ✓ Close To Town
- ✓ Close To Schools

### Climate Control

- ✓ Air Conditioning

### Garden

- ✓ Private

### Orientation

- ✓ South East
- ✓ South
- ✓ South West

### Views

- ✓ Sea
- ✓ Panoramic
- ✓ Pool
- ✓ Urban
- ✓ Street

### Security

- ✓ Entry Phone

### Condition

- ✓ Good

### Features

- ✓ Covered Terrace
- ✓ Fitted Wardrobes
- ✓ Near Transport
- ✓ Private Terrace
- ✓ Solarium
- ✓ Guest Apartment
- ✓ Storage Room
- ✓ Utility Room
- ✓ Ensuite Bathroom
- ✓ Barbeque

### Utilities

- ✓ Electricity
- ✓ Telephone

### Pool

- ✓ Private

### Kitchen

- ✓ Fully Fitted

### Category

- ✓ Resale

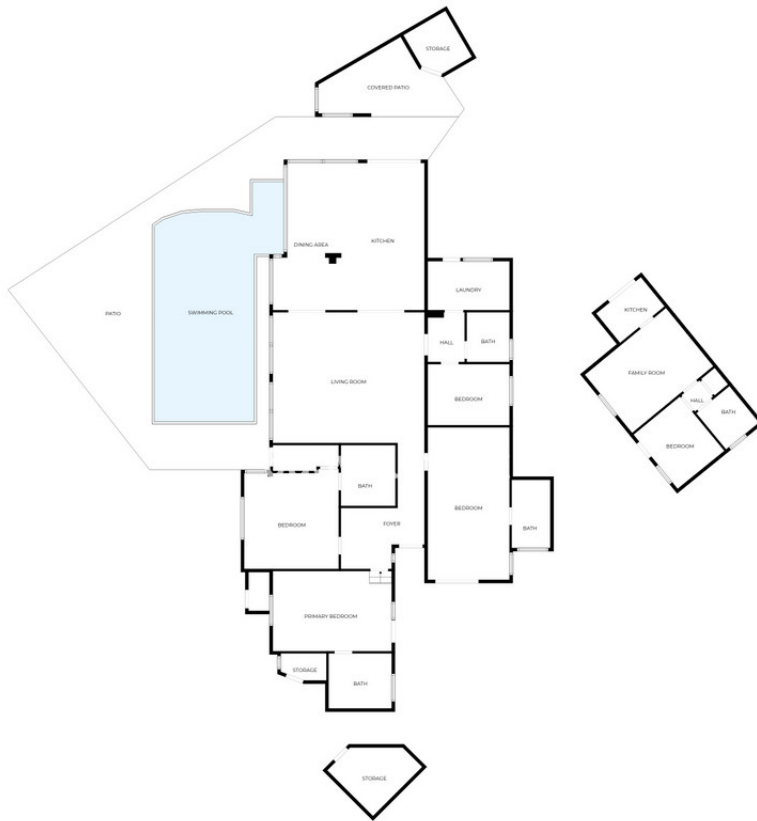

SIZES ARE APPROXIMATE, ACTUAL MAY VARY.

































