

Sales - Apartment - Puerto Banús

414.900€

Puerto Banús

Apartment

Community: 1,320 EUR / year IBI: 525 EUR / year

Rubbish: 92 EUR / year

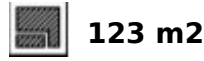

A rare opportunity located beside the popular Restaurante Samna, and within a short distance of Breath and the Puerto Banús Marina. This beautifully presented 2-bedroom, 2-bathroom apartment offers the perfect blend of lifestyle, location, and income potential — with a tourist rental licence already in place, something increasingly difficult to secure in Marbella today. Set within a gated and secure residential community, the property enjoys an enviable position in one of the Costa del Sol's most sought-after visitor locations. Beaches, the marina, dining, nightlife, and shopping are all within easy reach, making it a consistently high-demand destination for holidaymakers year-round. The apartment features a bright and comfortable living-dining area with direct access to a private terrace, ideal for outdoor dining while overlooking the communal gardens and swimming pool, with partial sea views further enhancing its holiday appeal. Two well-proportioned bedrooms and two bathrooms provide excellent comfort for families, couples, or groups. Residents and guests benefit from beautifully maintained communal gardens, multiple swimming pools, and sports facilities including tennis, paddle, and basketball courts, significantly enhancing both lifestyle enjoyment and rental desirability. The property further includes a secure underground private garage space and a separate storage room (trastero), offering valuable practicality, convenience, and peace of mind — particularly desirable in this prime location. Whether you are seeking a turn-key holiday home, a high-performing short-term rental investment, or a combination of both, this apartment represents a standout opportunity in today's market, combining prime location, an existing tourist licence, excellent amenities, and added storage and parking in one compelling package.

Setting

- ✓ Town
- ✓ Suburban
- ✓ Port
- ✓ Close To Port
- ✓ Close To Shops
- ✓ Close To Sea
- ✓ Close To Town
- ✓ Close To Schools
- ✓ Close To Marina
- ✓ Urbanisation

Climate Control

- ✓ Air Conditioning

Kitchen

- ✓ Fully Fitted

Utilities

- ✓ Electricity
- ✓ Drinkable Water
- ✓ Telephone

Orientation

- ✓ South East
- ✓ South

Views

- ✓ Sea
- ✓ Mountain
- ✓ Country
- ✓ Panoramic
- ✓ Garden
- ✓ Pool
- ✓ Courtyard

Garden

- ✓ Communal
- ✓ Landscaped
- ✓ Easy Maintenance

Category

- ✓ Bargain
- ✓ Holiday Homes
- ✓ Investment
- ✓ Resale
- ✓ Contemporary

Condition

- ✓ Excellent
- ✓ Good
- ✓ Recently Renovated
- ✓ Recently Refurbished

Features

- ✓ Covered Terrace
- ✓ Lift
- ✓ Fitted Wardrobes
- ✓ Near Transport
- ✓ Private Terrace
- ✓ WiFi
- ✓ Paddle Tennis
- ✓ Tennis Court
- ✓ Storage Room
- ✓ Ensuite Bathroom
- ✓ Access for people with reduced mobility
- ✓ Marble Flooring
- ✓ Double Glazing
- ✓ Near Church
- ✓ Fiber Optic

Security

- ✓ Gated Complex
- ✓ Entry Phone
- ✓ 24 Hour Security

Pool

- ✓ Communal
- ✓ Children's Pool

Furniture

- ✓ Fully Furnished
- ✓ Optional

Parking

- ✓ Underground
- ✓ Garage
- ✓ Communal
- ✓ Private

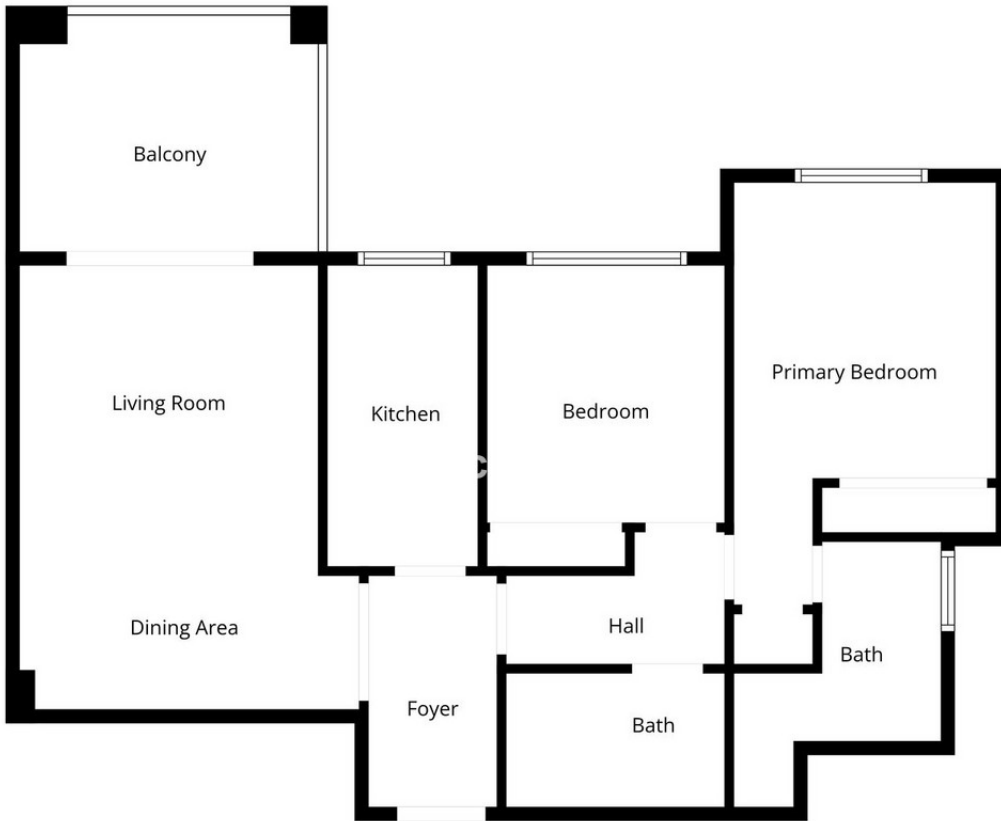

Floor Plan Created By Cubicasa App. Measurements Deemed Highly Reliable But Not Guaranteed.



















