

Sales - Apartment - Benalmadena Pueblo

449.000€

Benalmadena Pueblo

Apartment

Community: 1,296 EUR / year

IBI: 700 EUR / year



2



2



93 m2

Discover your new home in the heart of the Costa del Sol! This stunning, brand-new apartment boasts 2 spacious bedrooms and 2 modern bathrooms, designed for comfort and style. It's undeniable highlight is the terrace with breathtaking sea views, perfect for enjoying relaxing moments outdoors. - 93m² built area. - 23m² built area of the terrace. - 69m² usable area. The property has been customized with many extras, including a premium kitchen, top-of-the-line appliances, fully tiled bathrooms with shower enclosures, electric blinds, and more. The total value is over 10,000. Located in the exclusive Residencial Blossom II, just steps away from the charming Benalmádena Pueblo, this home combines the tranquility of a privileged setting with proximity to all amenities. The fully gated complex ensures security and privacy with surveillance cameras and concierge service. Plus, you'll have access to top-notch facilities: a refreshing community pool, a fully equipped gym, and a sophisticated gastroteca for sharing special moments with family and friends. Experience a modern, elegant, and Mediterranean lifestyle in this apartment that has it all!

Setting

- ✓ Village
- ✓ Close To Golf
- ✓ Close To Shops
- ✓ Close To Schools
- ✓ Close To Forest

Climate Control

- ✓ Air Conditioning
- ✓ Hot A/C
- ✓ Cold A/C

Kitchen

- ✓ Fully Fitted

Orientation

- ✓ South East

Views

- ✓ Sea
- ✓ Mountain
- ✓ Panoramic

Garden

- ✓ Communal

Condition

- ✓ Excellent
- ✓ New Construction

Features

- ✓ Covered Terrace
- ✓ Lift
- ✓ Fitted Wardrobes
- ✓ Near Transport
- ✓ Private Terrace
- ✓ Gym
- ✓ Storage Room
- ✓ Ensuite Bathroom
- ✓ Access for people with reduced mobility
- ✓ Double Glazing

Security

- ✓ Gated Complex
- ✓ Electric Blinds
- ✓ Entry Phone

Pool

- ✓ Communal

Furniture

- ✓ Not Furnished

Parking

- ✓ Underground
- ✓ Garage
- ✓ More Than One
- ✓ Communal



















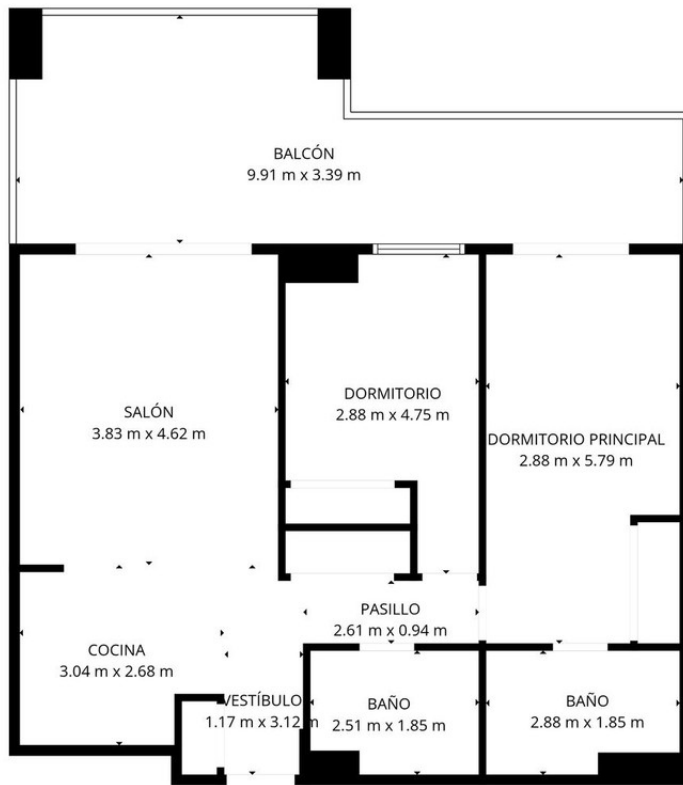

TOTAL: 75 m2
 Planta baja: 75 m2
 ÁREAS EXCLUIDAS: BALCÓN: 26 m2, MUROS: 5 m2

LAS MEDIDAS SON CALCULADAS UTILIZANDO LA TECNOLOGÍA CUBICASA. SON DE ALTA FIABILIDAD PERO NO GARANTIZADAS.