

Sales - Apartment - Benalmadena

439.000€

Benalmadena

Apartment

Community: 1,296 EUR / year

IBI: 700 EUR / year

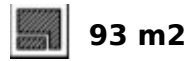

Modern New-Build Apartment with Panoramic Sea Views in Benalmádena Discover exceptional Mediterranean living in this stunning brand-new apartment with breathtaking panoramic sea views, located in the prestigious Blossom II development in Benalmádena. Designed for modern comfort and style, this elegant property offers 2 spacious bedrooms, 2 contemporary bathrooms, and bright open-plan living spaces that seamlessly connect to a spectacular 23 m² terrace. From here, you can enjoy uninterrupted views of the Mediterranean Sea, stunning sunrises, and unforgettable sunsets all year round. Property Features * 2 Bedrooms * 2 Bathrooms * 93 m² built area * 69 m² usable interior area * 23 m² private terrace with panoramic sea views * Brand-new apartment * Premium upgraded kitchen * High-end appliances included * Fully tiled bathrooms with shower enclosures * Electric blinds * Additional upgrades and extras valued at over €10,000 * Bright and modern open-plan layout Located in the exclusive gated community of Blossom II, this apartment enjoys a privileged position just minutes from Benalmádena Pueblo and within easy reach of everything you need for everyday living. Prime Location * Walking distance to restaurants, cafés and local shops * Close to supermarkets and medical clinics * Near international and local schools * Excellent access to public transport and bus stops * Just minutes from Benalmádena Pueblo * Short drive to beaches, golf courses and marinas * Approximately 15 minutes from Málaga International Airport Residents benefit from outstanding communal facilities including: ✓ Swimming pool ✓ Fully equipped gymnasium ✓ Elegant gastroteca and social area ✓ Concierge service ✓ Security cameras throughout the complex ✓ Secure gated access Whether you are looking for a permanent residence, a holiday home, a rental investment, or a lock-up-and-leave property on the Costa del Sol, this exceptional apartment offers the perfect combination of luxury, convenience, and panoramic sea views. Experience the very best of the Costa del Sol lifestyle in one of Benalmádena's most desirable new developments.

Setting

- ✓ Town
- ✓ Close To Shops
- ✓ Close To Town
- ✓ Close To Schools
- ✓ Urbanisation

Climate Control

- ✓ Air Conditioning

Kitchen

- ✓ Fully Fitted

Utilities

- ✓ Electricity
- ✓ Drinkable Water
- ✓ Solar water heating

Orientation

- ✓ South

Views

- ✓ Sea

Garden

- ✓ Communal
- ✓ Easy Maintenance

Category

- ✓ Bargain
- ✓ Cheap
- ✓ Distressed
- ✓ Investment
- ✓ Reduced
- ✓ Resale
- ✓ Contemporary

Condition

- ✓ Excellent
- ✓ Good
- ✓ New Construction

Features

- ✓ Covered Terrace
- ✓ Lift
- ✓ Fitted Wardrobes
- ✓ Near Transport
- ✓ Private Terrace
- ✓ Gym
- ✓ Storage Room
- ✓ Utility Room
- ✓ Ensuite Bathroom
- ✓ Access for people with reduced mobility
- ✓ Double Glazing
- ✓ Basement

Security

- ✓ Gated Complex
- ✓ Entry Phone

Pool

- ✓ Communal

Furniture

- ✓ Not Furnished

Parking

- ✓ Underground
- ✓ Garage
- ✓ More Than One











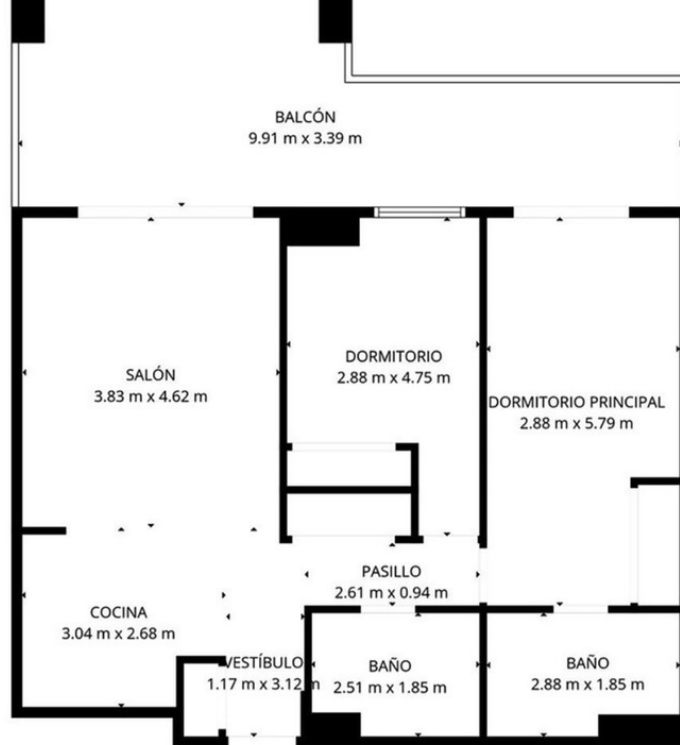

TOTAL: 75 m²
 Planta baja: 75 m²
 ÁREAS EXCLUIDAS: BALCÓN: 26 m², MUROS: 5 m²

LAS MEDIDAS SON CALCULADAS UTILIZANDO LA TECNOLOGÍA CUBICASA, SON DE ALTA FIDELIDAD PERO NO GARANTIZADAS.















