

Ref.-ID: MIBGR5350723

Marbella

Apartment

Community: 9,348 EUR / year IBI: 1 EUR / year

Rubbish: 180 EUR / year



3



2



140 m2

Lets Do this different, Welcome to Palo Alto community, where this stunning, newly built 3-bedroom Palo Alto got a great blend of peace and proximity. You're just 5 minutes from La Cañada Shopping Center, less than 10 minutes from Marbella's Old Town and marina, and 15 minutes from Puerto Banús. Málaga Airport is conveniently reachable in just 35 minutes. Whether you're looking for a luxurious primary residence, a vacation home, or a strong investment this one can do it all. penthouse with easy flow, sea views and in the middle of it all a mountain, Kitchen mixed with the living room and outside makes it feel bigger than it is, and connects all corners. Floor-to-ceiling glass doors open onto the terrace underfloor heating throughout, individual air conditioning in each room via Airzone. This exceptional property also includes two large underground parking spaces and a spacious private storage room. Classified in Marbella but 7 minutes above LA CANADA with 24/7 security, this penthouse offers access to in my opinion one of the best facilities on site which includes fitness and spa center, featuring a heated indoor pool spa with sauna, Turkish bath, ice bath, and a co-working space for remote professionals. All of these facilities are included in the community fee.

**Setting**

- ✓ Close To Town
- ✓ Close To Schools
- ✓ Urbanisation

**Climate Control**

- ✓ Air Conditioning
- ✓ Central Heating
- ✓ U/F Heating

**Kitchen**

- ✓ Fully Fitted

**Orientation**

- ✓ South
- ✓ South West

**Views**

- ✓ Sea
- ✓ Mountain

**Security**

- ✓ Gated Complex
- ✓ Alarm System
- ✓ 24 Hour Security

**Condition**

- ✓ Excellent

**Features**

- ✓ Covered Terrace
- ✓ Lift
- ✓ Fitted Wardrobes
- ✓ Private Terrace
- ✓ Gym
- ✓ Sauna
- ✓ Tennis Court
- ✓ Ensuite Bathroom
- ✓ 24 Hour Reception

**Parking**

- ✓ Underground

**Pool**

- ✓ Communal

**Furniture**

- ✓ Fully Furnished

**Category**

- ✓ Resale















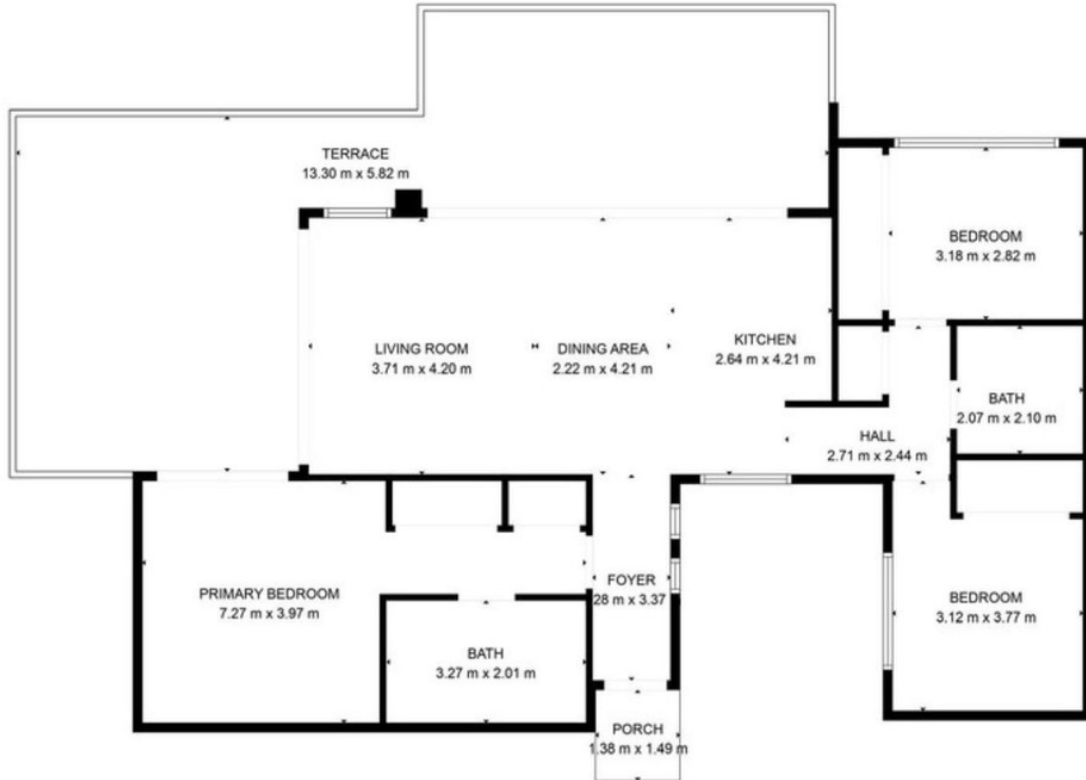

**TOTAL: 104 m2**  
 FLOOR 1: 104 m2  
 EXCLUDED AREAS: TERRACE: 52 m2, PORCH: 2 m2, WALLS: 9 m2

FLOOR PLAN CREATED BY CUBICASA APP. MEASUREMENTS DEEMED HIGHLY RELIABLE BUT NOT GUARANTEED.

