

**Ref.-ID: MIBGR5361490**

**Benalmadena Pueblo**

**Apartment**

**Community: 1,296 EUR / year**

**IBI: 700 EUR / year**



**2**



**2**



**93 m2**

Discover your new home in the heart of the Costa del Sol! This stunning, brand-new apartment boasts 2 spacious bedrooms and 2 modern bathrooms, designed for comfort and style. It's undeniable highlight is the terrace with breathtaking sea views, perfect for enjoying relaxing moments outdoors. - 93m<sup>2</sup> built area. - 23m<sup>2</sup> built area of the terrace. - 69m<sup>2</sup> usable area. The property has been customized with many extras, including a premium kitchen, top-of-the-line appliances, fully tiled bathrooms with shower enclosures, electric blinds, and more. The total value is over €10,000. Located in the exclusive Residencial Blossom II, just steps away from the charming Benalmádena Pueblo, this home combines the tranquility of a privileged setting with proximity to all amenities. The fully gated complex ensures security and privacy with surveillance cameras and concierge service. Plus, you'll have access to top-notch facilities: a refreshing community pool, a fully equipped gym, and a sophisticated gastroteca for sharing special moments with family and friends. Experience a modern, elegant, and Mediterranean lifestyle in this apartment that has it all!

**Setting**

- ✓ Village
- ✓ Close To Golf
- ✓ Close To Shops
- ✓ Close To Schools
- ✓ Close To Forest

**Climate Control**

- ✓ Air Conditioning
- ✓ Hot A/C
- ✓ Cold A/C

**Kitchen**

- ✓ Fully Fitted

**Orientation**

- ✓ South East

**Views**

- ✓ Sea
- ✓ Mountain
- ✓ Panoramic

**Garden**

- ✓ Communal

**Condition**

- ✓ Excellent
- ✓ New Construction

**Features**

- ✓ Covered Terrace
- ✓ Lift
- ✓ Fitted Wardrobes
- ✓ Near Transport
- ✓ Private Terrace
- ✓ Gym
- ✓ Storage Room
- ✓ Ensuite Bathroom
- ✓ Access for people with reduced mobility
- ✓ Double Glazing

**Security**

- ✓ Gated Complex
- ✓ Electric Blinds
- ✓ Entry Phone

**Pool**

- ✓ Communal

**Furniture**

- ✓ Not Furnished

**Parking**

- ✓ Underground
- ✓ Garage
- ✓ More Than One
- ✓ Communal



















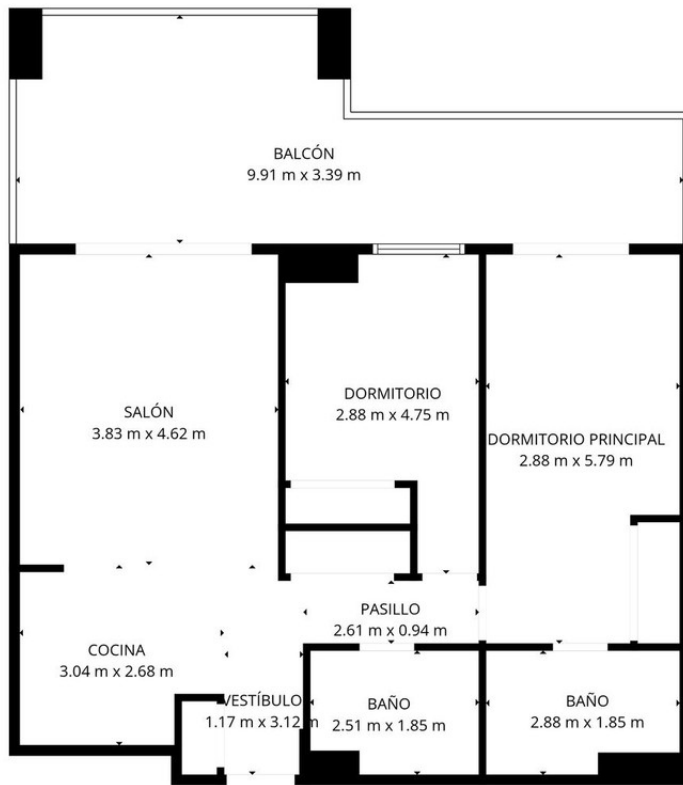

**TOTAL: 75 m2**  
 Planta baja: 75 m2  
 ÁREAS EXCLUIDAS: BALCÓN: 26 m2, MUROS: 5 m2

LAS MEDIDAS SON CALCULADAS UTILIZANDO LA TECNOLOGÍA CUBICASA. SON DE ALTA FIABILIDAD PERO NO GARANTIZADAS.