

Продажа - Апартамент - Benahavís

839.000€

Benahavís

Апартамент



2



2



108 m2

This exclusive 2-bedroom, 2-bathroom penthouse offers an unparalleled lifestyle in one of the most prestigious communities on the Costa del Sol. Featuring a modern, bright design, high-end finishes, and a fully equipped kitchen, this property combines comfort and elegance. The master bedroom includes an en-suite bathroom, while the spacious private balcony boasts breathtaking views of the sea, Gibraltar, and Africa. The highlight of the apartment is its rooftop terrace, perfect for relaxing and enjoying stunning panoramic views of the mountains and the prestigious Villa Padierna. The complex offers top-tier amenities, including 12 outdoor pools, a heated indoor pool, a fully equipped gym, spa, sauna, jacuzzi, and outdoor training areas. Residents also enjoy an infinity pool with panoramic views, yoga spaces, a restaurant, a clubhouse, and a coworking area. The gated community provides 24/7 security and concierge services, ensuring comfort and peace of mind. Ideally located just minutes from Benahavís, Marbella, Puerto Banús, and Estepona, this penthouse offers easy access to world-class golf courses, international schools, beaches, and hiking trails.

Расположение

- ✓ Горная деревня
- ✓ Рядом с гольф-полем
- ✓ Рядом с городом
- ✓ Близко к школам
- ✓ Урбанизация

Климат-контроль

- ✓ Кондиционер

Сад

- ✓ Общественный

ОРИЕНТАЦИЯ

- ✓ Юго-запад

ВИД

- ✓ Море
- ✓ Горы
- ✓ Гольф
- ✓ Сельская местность
- ✓ Панорамный

меры безопасности

- ✓ Огражденный комплекс
- ✓ Охрана 24 часа

Состояние

- ✓ Отличное

Особенности

- ✓ Приватная терраса
- ✓ Солярий
- ✓ Тренажерный зал

Парковка

- ✓ Приватная

бассейн

- ✓ Общий
- ✓ Закрытый

Мебель

- ✓ Полностью меблированный































Vivienda Ático 2 dormitorios con terraza

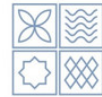

PARAISOPUEBLO
BENAHAVÍS

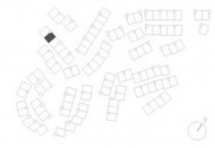

SALÓN	14,95 m ²
COCINA	14,53 m ²
DISTRIBUIDOR	2,51 m ²
DORMITORIO 1	15,53 m ²
BAÑO 1	5,56 m ²
DORMITORIO 2	10,99 m ²
BAÑO 2	3,37 m ²
SUPERFICIE ÚTIL TOTAL	87,52 m²
TERRAZA	16,36 m ²
SOLARIUM	91,21 m ²
SUPERFICIE EXTERIOR ÚTIL TOTAL	107,57 m²
APARCAMIENTO (B62 -6)	15,49 m ²
TRASTERO (B62 -10)	5,67 m ²

Superficies según Decreto 218 / 2005
SUP. ÚTIL TOTAL 96,27 m²

SUPERFICIE CONSTRUIDA TOTAL 191,15 m²

