

**Ref.-ID: MIBGR5019289**

**Puerto Banús**

**Апартамент**

**Коммунальные: 1,680 EUR / год**

**ИБИ: 1,184 EUR / год**

**Мусор: 368 EUR / год**



**3**



**2**



**129 m2**

This is a Beautifully Renovated 2(3)-Bedroom Apartment in the Heart of Puerto Banús Marina with parking. Description: Discover this exceptional 2(3)-bedroom apartment perfectly situated in the vibrant Puerto Banús marina. Offering 129m<sup>2</sup> of stylish living space, this home combines modern comfort with unbeatable convenience. This is an exclusive listing presented by Costa del Sol Property. The apartment has been recently renovated and features two spacious bedrooms, two elegant bathrooms, a bright and airy living room with plenty of space for both lounge and dining areas, and a separate kitchen that enhances the open, spacious feel. A French balcony adds charm, while direct lift access from the underground garage ensures both comfort and security. Fully furnished and equipped with hot and cold A/C, this apartment is ready to move into or rent out immediately. Key Features: 129m<sup>2</sup> of living space 2 large bedrooms & 2 modern bathrooms - and possibility of a third bedroom. Spacious living and dining area Separate fully equipped kitchen French balcony (Possibility for the second bedroom) Underground garage with direct lift access Fully furnished, with A/C hot & cold Prime Location: Just steps away from sandy beaches, designer boutiques, exclusive restaurants, trendy bars, and the world-famous Puerto Banús nightlife. Everything you need is within walking distance. Investment Opportunity: The property is rented out on a short-term basis, and the new owner has the option to continue with the rental arrangement, ensuring income from day one. Don't miss the chance to own a stylish apartment in one of Marbella's most desirable locations.

**Расположение**

- ✓ Город
- ✓ Коммерческая зона
- ✓ На побережье
- ✓ Порт
- ✓ Рядом с портом
- ✓ Рядом с магазинами
- ✓ Рядом с морем
- ✓ Рядом с городом
- ✓ Близко к школам
- ✓ Порт
- ✓ Рядом с портом
- ✓ Урбанизация

**ВИД**

- ✓ Город
- ✓ Улица

**меры безопасности**

- ✓ Сигнализация

**ОРИЕНТАЦИЯ**

- ✓ Юг

**Особенности**

- ✓ Крытая терраса
- ✓ Встроенные шкафы
- ✓ Рядом с транспортом
- ✓ Приватная терраса

**Парковка**

- ✓ Подземная
- ✓ Гараж

**Состояние**

- ✓ Недавно отремонтированная
- ✓ Недавно отделанная

**Мебель**

- ✓ Полностью меблированный

**Коммунальные услуги**

- ✓ Электричество

**Климат-контроль**

- ✓ Кондиционер

**Кухня**

- ✓ Полностью оборудованная

**Категория**

- ✓ Инвестиции



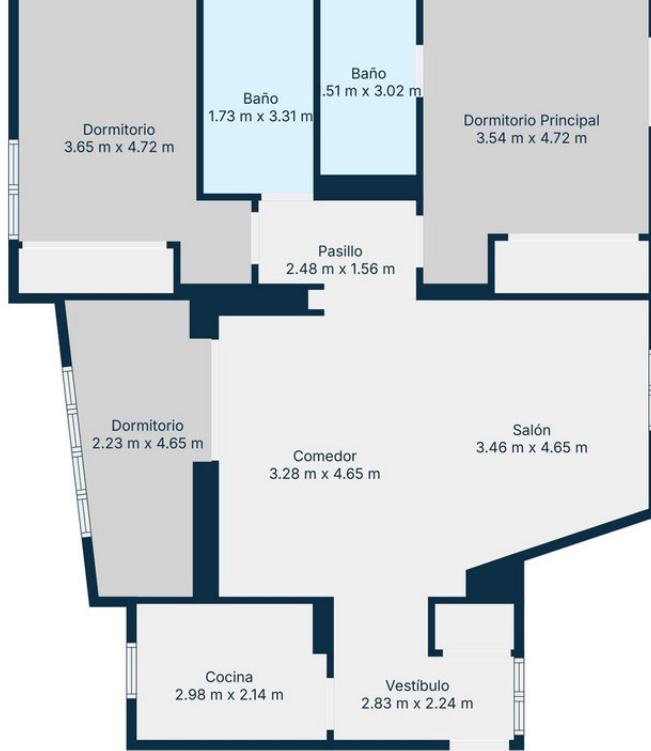

**TOTAL: 101 m<sup>2</sup>**  
 1. PLANTA: 101 m<sup>2</sup>  
 ÁREAS EXCLUIDAS: MUROS: 7 m<sup>2</sup>

Las Medidas Son Calculadas Utilizando La Tecnologia Cubicasa. Son De Alta Fiabilidad Pero No Garantizadas.











































