



Продажа - Участок - Benalmadena
350.000€

www.mibgroup.es
+34 661 89 71 88
info@mibgroup.es

Ref.-ID: MIBGR5298097

Benalmadena

Участок



642 m2

EXCLUSIVE PLOT FOR SALE IN SANTANGELO - BENALMÁDENA Ideal for a single-family home | High-end residential area A unique opportunity to purchase an urban plot in the prestigious Santangelo Norte area, one of the most sought-after and peaceful areas of Benalmádena, perfect for building your dream home or as an investment with high potential for appreciation. Privileged location Located in an exclusive residential setting, surrounded by nature, high-end villas and with excellent connections. Just a few minutes from the coast, amenities, schools, motorway access and the town centre. Urban plot Surface area: 624 m² Use: Detached house Consolidated and highly sought-after area Ideal for a high-end detached house project Ideal for: End clients seeking tranquillity, privacy and quality of life Investors wishing to develop a property in a premium area with high demand and future profitability Exclusive surroundings, unobstructed views and maximum privacy, in one of the most prestigious developments on the Costa del Sol. Request more information and don't miss this unique opportunity in Santangelo.

Категория

- ✓ Выгодное предложение
- ✓ Дешевая
- ✓ Описанная за долги
- недвижимость
- ✓ Инвестиции
- ✓ Элитная







TOPOGRÁFICO MODIFICADO

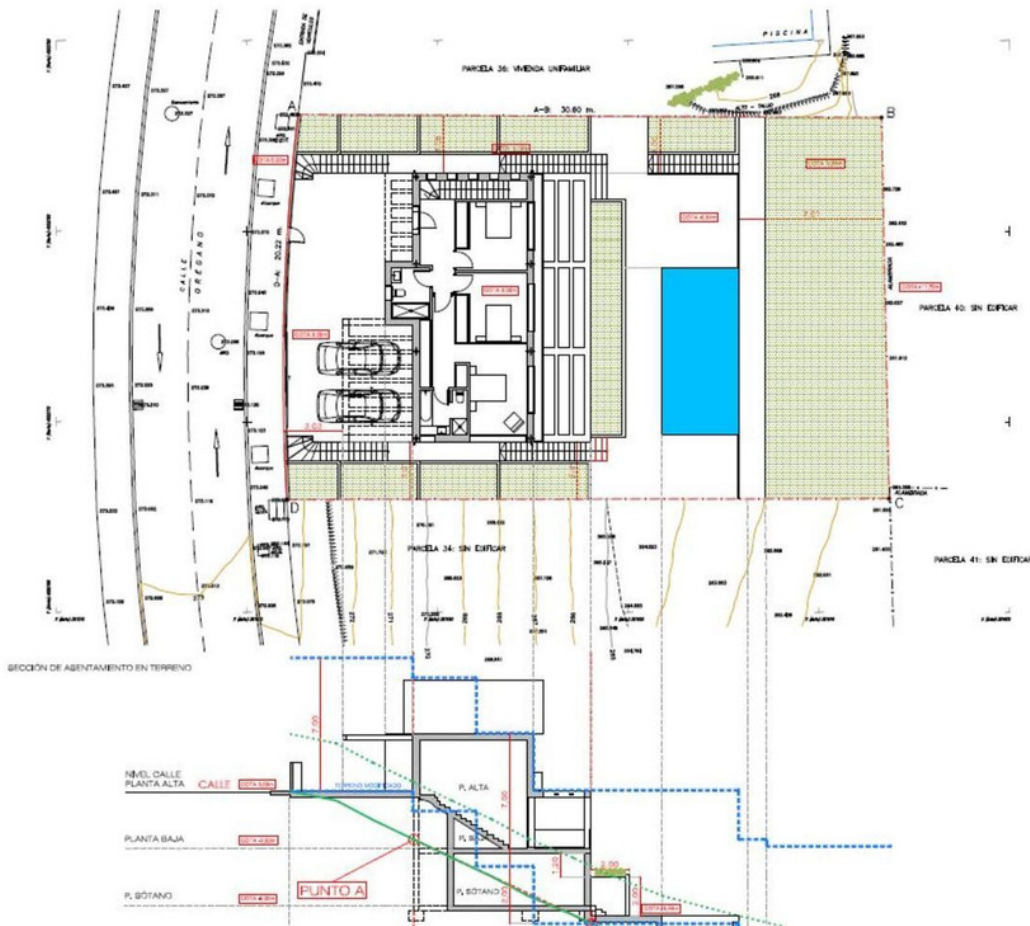



INFORMACIÓN CARTOGRÁFICA

1. ELIPSOIDE INTERNACIONAL
2. SISTEMA DE REFERENCIA; E,T,R,S,89
3. PROYECCIÓN CARTOGRÁFICA; UTM, USO 30
4. ALTITUD ORTOMÉTRICA; GEODE EGM8, IGN
5. ESTACIÓN PERMANENTE; IGN

NOTAS TOPOGRÁFICAS:

1. LAS LINDES CONSIDERADAS HAN SIDO INDICADAS POR LA PARTE ENCARGADA
2. NUMERACIÓN DE CUADRÍCULA: SISTEMA UTM
3. ORIENTACIÓN NORTE GEOGRÁFICO
4. SISTEMA ANGULAR: RADIANES PLANOS
5. FORMATO A1 SEGÚN NORMA ISO 216 - DIN 476

SIMBOLOGÍA:

-  LINDE (TRANSPARENTE)
-  LINDE (FÍSICA)
-  ALAMBRADA - TELA METÁLICA
-  MUROS - CERRAMIENTO
-  BORDILLO

